

These are the benefits

- Decrease of print costs and increase of business and user efficiency
- Documents follow users to their choice of printer
- Tracking of print and copy activity
- Any public workgroup printer is turned into a personal printer
- Utilization of printers is optimized
- Quota and fee-based printing and copying solution
- Ready for enterprise-wide and mission critical printing

Companies and organizations in the process of evaluating their printing solution may find that it does not support their business and is not as cost effective as they want. With balanced deployment of workgroup printers, modern Multi Function Printers (MFPs) and SafeCom G2 server software you can decrease print costs and increase business and user efficiency.

How does it work

SafeCom is a modular system that can be enhanced with add-on modules to build customer specific and scalable solutions. If printers are SafeCom-enabled users can walk to any of these printers, identify themselves and collect their documents (Pull Print). On MFPs, users identify themselves the same way to access copying functionality (Copy Control).

SafeCom can track data about SafeCom print and copy jobs, including; owner, number of pages, paper size, and possible use of color and duplex. Documents that are printed directly to printers (Push Print) can also be tracked (no need for special hardware at the printers).

Tracking data can be used to invoice users or users' departments based on organizational relations. Tracking data can also be used if printer fleet management is outsourced on a pay-per-use basis.

Users can be made to prepay for printing and copying. Users are prevented from printing and copying if the balance of their account goes below a specified limit.

SafeCom requires only software to be installed on a Windows server. Setup can be limited to adding or modifying one or more shared printers.

Characteristics

- Scalable solution using multiple servers working together to support as many printers and users as required and allow users to roam between locations.
- Highly available solution with Microsoft Cluster Service support: If one server fails another takes over.
- Ready for enterprise-wide and mission critical printing.
- Documents follow users to their choice of printer - user identification at the printer is by means of a card and/or code. If a printer is down users can just login at another.
- On MFPs users can be asked to identify themselves before access is granted to copying.
- Tracking of print and copy usage and use the recorded data for subsequent departmental invoicing.
- Documents printed directly to the printer can be tracked without the need of special hardware.
- Allows users to pay up-front for printing and copying; users can revalue their account themselves on the Internet via SafeCom ePay or by depositing notes and coins in the SafeCom Money Loader.
- Protect print data on the network with optional encryption.
- Restrict users' access to printers.

Areas of application

- Any company or organization that want document security and to decrease print costs and increase business and user efficiency.
- To balance deployment of devices using cost-effective workgroup printers for personal printing - without jeopardizing document security.
- Outsourced printer fleet management solutions.
- Educational institutions in need of a quota-based and/or fee-based printing and copying solution.
- Libraries that wish to offer a fee-based printing and copying solution.
- Health sector for secure printing of medical records.

SafeCom a/s
Vadstrupvej 37 A
DK-2880 Bagsvaerd
Denmark

Phone: +45 4436 0240
Fax: +45 4436 0248
E-mail: info@safecom.dk
Web: safecom.dk

A Modular System

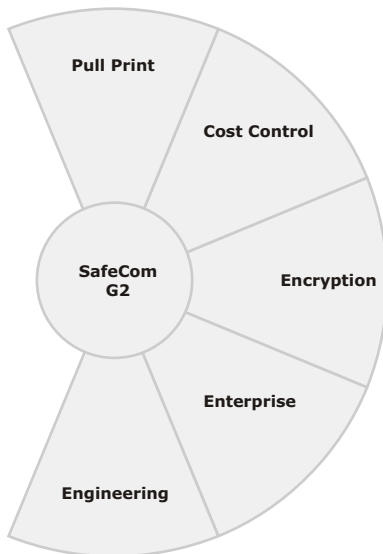

SafeCom G2

- Core server and client software.

Pull Print

- Documents follow users to their choice of printer. User identification at the printer is by means of a card and/or code.

Cost Control

- **Tracking** - Monitors print and copy usage and uses the recorded data for subsequent departmental invoicing. Printer must support PCL or PostScript.
- **Pay** - Is an add-on module to Tracking and allows users to pay up-front for printing and copying.

Encryption

- Protects print data on the network.

Enterprise

- **Multi Server Support** - Scalability; multiple SafeCom servers work together allowing users to roam between locations.
- **Cluster Support** - Availability; if one server fails another takes over.

Engineering

- **APIs** - Automates tasks and integrates SafeCom with other systems.
- **Development** - Customized development.

System Requirements

Server

Windows XP, 2003 and 2000.
SafeCom License key code.
Recommended: 1GHz CPU and 512 MB RAM. 1 GB of free disk space.

Database

The free Microsoft SQL Desktop Engine (MSDE) is distributed with SafeCom. In a SafeCom G2 multi server installation the master server must run Microsoft SQL Server on either a Windows Server 2003 or a Windows 2000 Server.

Client

Windows XP, 2003, 2000, NT 4, 98 and clients running Citrix and Windows Terminal Service.
Recommended: 400 Mhz CPU and 256 MB RAM. 100 MB of free disk space.

Network protocol

TCP/IP.

Identification Methods

Pull Print requires users to be identified at the printer. Please contact us to hear about other methods than those below:

- User code (1-10 digits)
- Magnetic Card (Track 2)
- EM41xx Proximity Card
- HID Proximity Card
- HITAG Proximity Card
- Indala Proximity Card
- Legic Proximity Card
- Mifare Proximity Card
- NEDAP Proximity Card

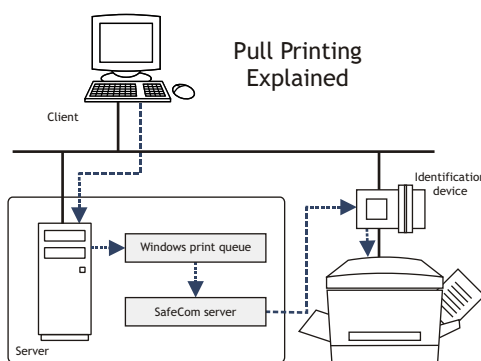

Printers

Pull Print requires the printer to be SafeCom-enabled.

External solution

Any printer with a parallel port (IEEE 1284) or network connection can be SafeCom-enabled with the SafeCom Controller and a standalone card reader or SafeCom Front-end (touch-screen and built-in card reader).

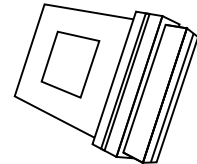

HP LaserJets

The internal SafeCom Go (DIMM) is available for these HP LaserJet printers equipped with HP JetDirect-network cards:

- HP LaserJet 4100mfp (*)
- HP LaserJet 9000mfp (*)
- HP LaserJet 9055mfp
- HP LaserJet 9065mfp
- HP LaserJet 4200
- HP LaserJet 4300
- HP Color LaserJet 4600
- HP Color LaserJet 5500
- HP Color LaserJet 9500 (*)

(*) Features a built-in numeric keypad which allow users to be identified by means of a numeric code.

User interface is integrated into the HP printer's menu structure.

Copy Control on MFPs

Copy control is supported on selected MFPs from these manufactures:

- Canon
- HP
- Ricoh
- Sharp
- Xerox

The MFP must be networked and in most cases you need a special SafeCom MFP cable. For complete list please refer to *SafeCom G2 Administrator's Manual D60600*.